

SA-1000-3 SA-1000S-3



Easy Operation

- Touch screen for easy operation
- Multicolor operation keys for improved visibility and ease of use
- Two-language exchange (English and Spanish)



**LM Guide
THK linear motion rails on all axis**

To minimize the vibration and provide high rigidity and stability.



**Saving Energy
Reduced power and air consumption.**

25% Power consumption reduced by 25% 75% Air consumption reduced by 75%



**Injection Press Range
80~300 ton**

COMMON SPECIFICATIONS

| Power Source | Air Pressure | Drive System | Posture (Air Cylinder) | Air Cylinder Driving Force (Air Pressure at 0.49Mpa) | | Control Box |
|---|----------------------|----------------|------------------------|--|-----------------------|-------------|
| | | | | Max. Load | Posture Torque | |
| AC200~220V ±10 50/60Hz Single Phase | 0.49 Mpa (71 psi) | AC Servo Motor | 90°Fixed | 5 kg (11 lbs) Incl Chuck Weight | 12.9 N•m (9.5 ft-lbs) | STEC-NC2a |
| | | | | | | |

GENERAL SPECIFICATIONS

| Model | Stroke (mm) | | | | Electric Consumption (KVA) | Max Power Consumption (KW) | Net Weight (kg) | | Air Consumption |
|------------|-------------|-----------|-----------|----------|----------------------------|----------------------------|-----------------|---------|----------------------------|
| | ⓅVertical | ⓇVertical | Crosswise | Traverse | | | Main Body | Pendant | |
| SA-1000-3 | 1000 | - | 690 | 1800 | 1.4 | 1.1 | 207 | 1.1 | 1.40 L/Cycle (0.05 ft³) |
| SA-1000S-3 | | 1050 | 520 | | 2.6 | 1.7 | 225 | | |

* Net weight includes the weight of interlock box and driver box.

* In the column of stroke, Ⓟstands for product side arm and Ⓡstands for runner side arm.

STANDARD FUNCTIONS

| | | | |
|--|---|--|--------------------------------------|
| Extract descent standby | Energy saving vacuum confirmation unit (1circuit) | Ejector forward & return link | Runner release within mold |
| Crosswise product extract side posture control | Free extract for under-cut mold | Midway runner release (Advance & Return) | Extraction from fixed mold |
| Crosswise Free Servo point | Posture control during traverse | Posture midway descent at release side | Defective product reject |
| Initial defective product reject | Delayed traverse | Two language exchange (English, Spanish) | Standard packaging |
| Free packaging (100 points × 2 stage) | Start signal of conveyor | Servo sleep feature | Easy NC steps (USER PROGRAM EDITING) |
| External storage memory | Default blind feature | Backlight Auto OFF | |

OPTION FUNCTIONS

| | | | |
|--|-----------------------------------|---|---|
| Vacuum confirmation unit (2 or 4 circuits) | Chuck pressure regulator | Air nipper in chuck circuit | Release product at two different points |
| Release product at four different points | Alarm Lamp (Red color,w/o buzzer) | NT gate cutting on crossmember of moving mold side (w/unit) | |

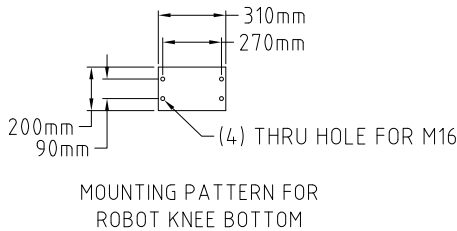
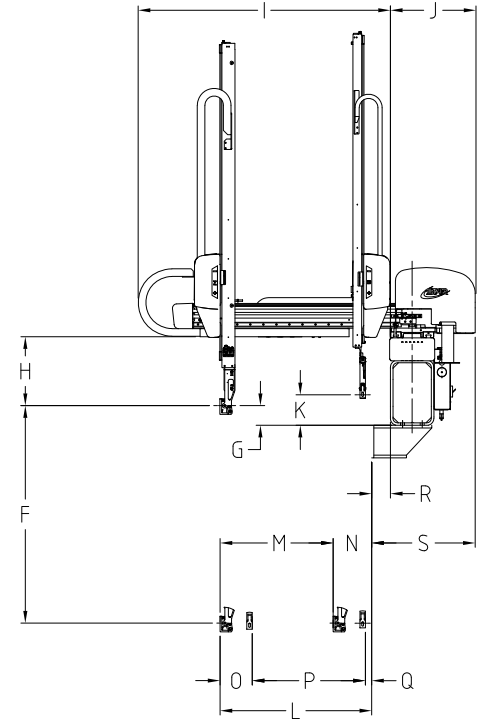
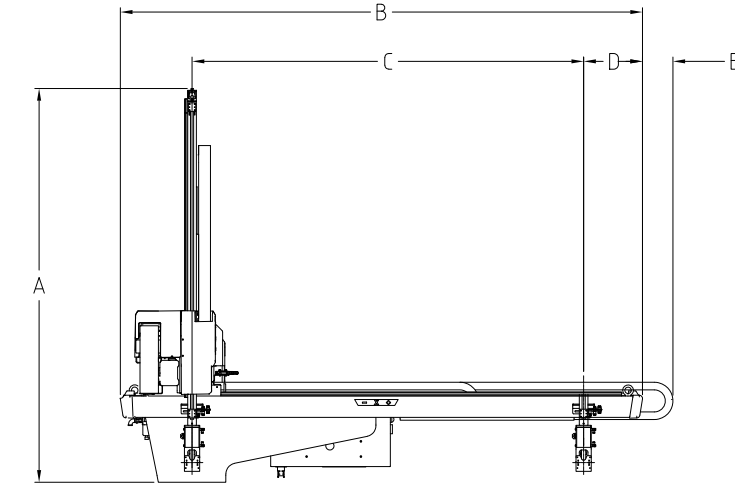

| OUTER DIMENSIONS (mm) | | SA-1000-3 | SA-1000S-3 |
|-----------------------|---|-----------|------------|
| A | Overall height | 1810 | 1810 |
| B | Overall width | 2400 | |
| C | Traverse stroke | 1800 | |
| D | Overhang, release side | 270 | |
| E | Cable guide overhang | 140 | |
| F | (P) Vertical Stroke | 1000 | |
| G | (P) Vertical Standby | 90 | |
| H | Bottom of crosswise to chuck mount position | 317 | |
| I | Crosswise arm | 1160 | |
| J | Thickness | 393 | |
| K | (R) Vertical standby | – | 140 |
| L | (P) Crosswise reach max | 697 | |
| M | (P) Crosswise stroke max | 690 | 520 |
| N | (P) Crosswise standby min | 11 | 177 |
| O | (P) (R) Proximity min | – | 148 |
| P | (R) Crosswise stroke min | – | 520 |
| Q | (R) Crosswise standby min | – | 29 |
| R | Base Offset | 86 | |
| S | Mold Mounting Face - Box End | 479 | |

All stated here is subject to change without notice.